



Lumbini Project

ルンビニプロジェクト

What's Lumbini?





Nepal 南部

Indiaと接するタライ平原



Nepal 南部

Indiaと接するタライ平原

仏陀の生誕地である。

仏教4大聖地の一つ。

1:生誕の地ルンビニ Lumbini

2:悟りの地ブッダガ Bodhgaya

3:最初に説法したサールナート
Sarnath

4:入滅の地クシナガラ
Kushinagar

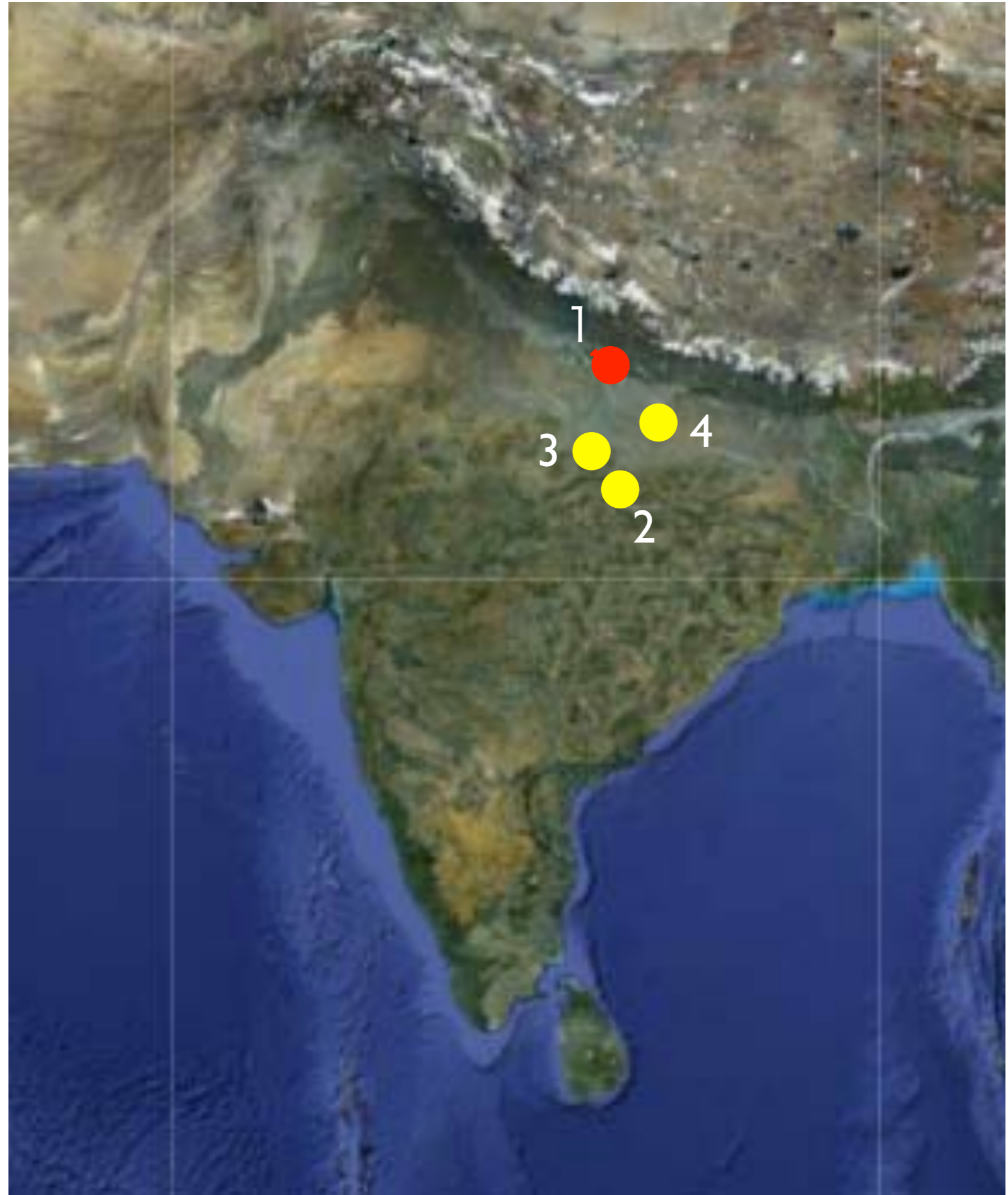





KENZO TANGE

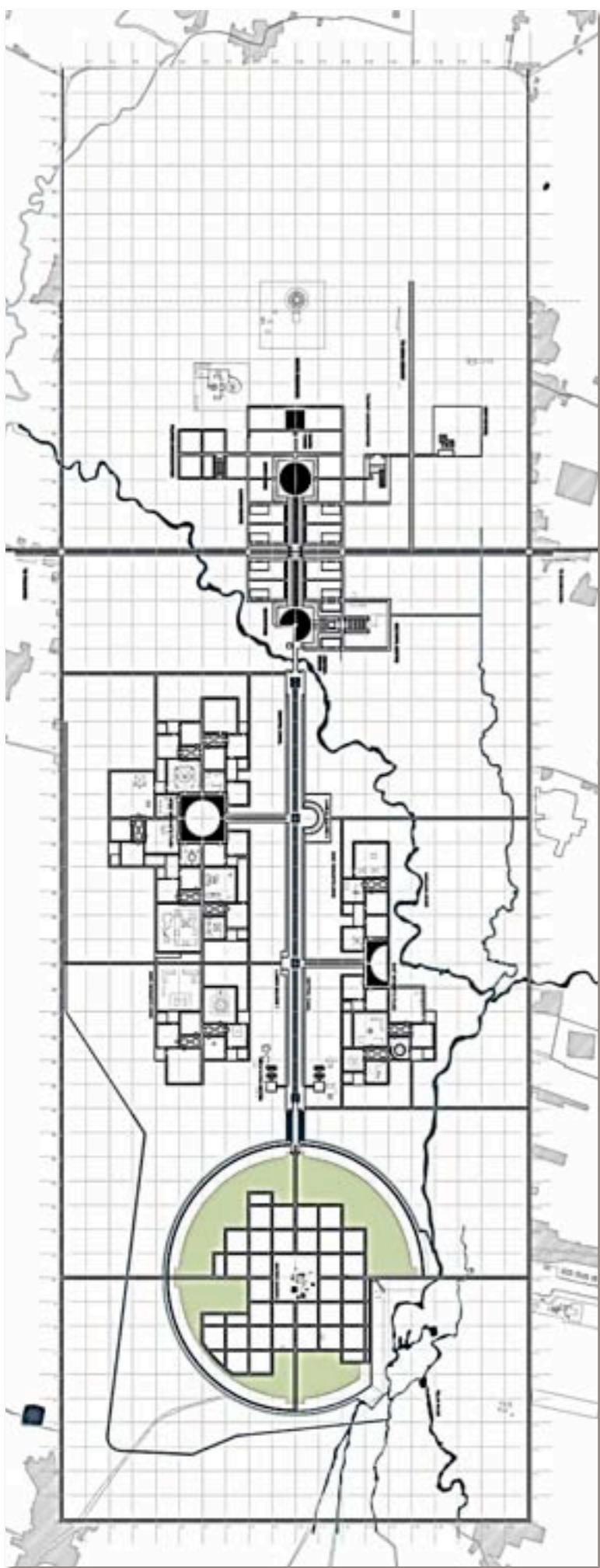

Image by Google Earth



MEMBERS

PROF. NISHIMURA YUKIO

ASSISTANT PROF. KUROSE TAKEFUMI

FU SHULAN (D3)

PUNNOI NATTAPONG (D3)

ABDULLA AHLAM MOHAMED SALEH(D1)

LEE BONGHO (M2)

NAKAMURA TAKAFUMI (M1)

ISHIGURO TATSUYA (M1)

周辺調査

RESEARCH OF SURROUDING SITES

Existing Conditions of Monastic Zone

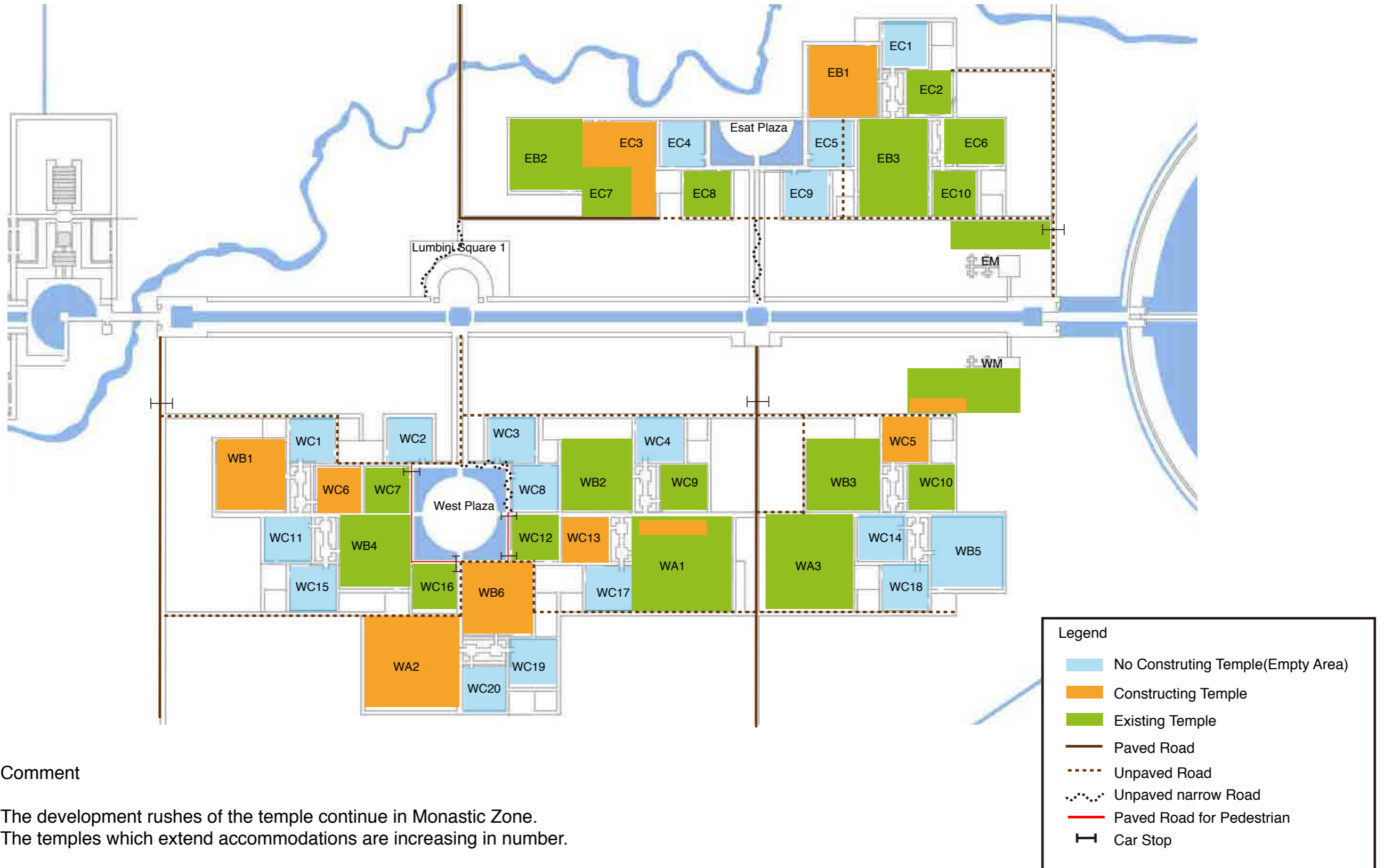

Comment

The development rushes of the temple continue in Monastic Zone. The temples which extend accommodations are increasing in number.



□□□□□□□ □□□□□□□ □□ □□ □□□□□□□□ □□□□□□□□□□ □□□□□□□□□ □□□□□



動線計画

FLOW DESIGN PLANNING

● Existing Traffic Flow

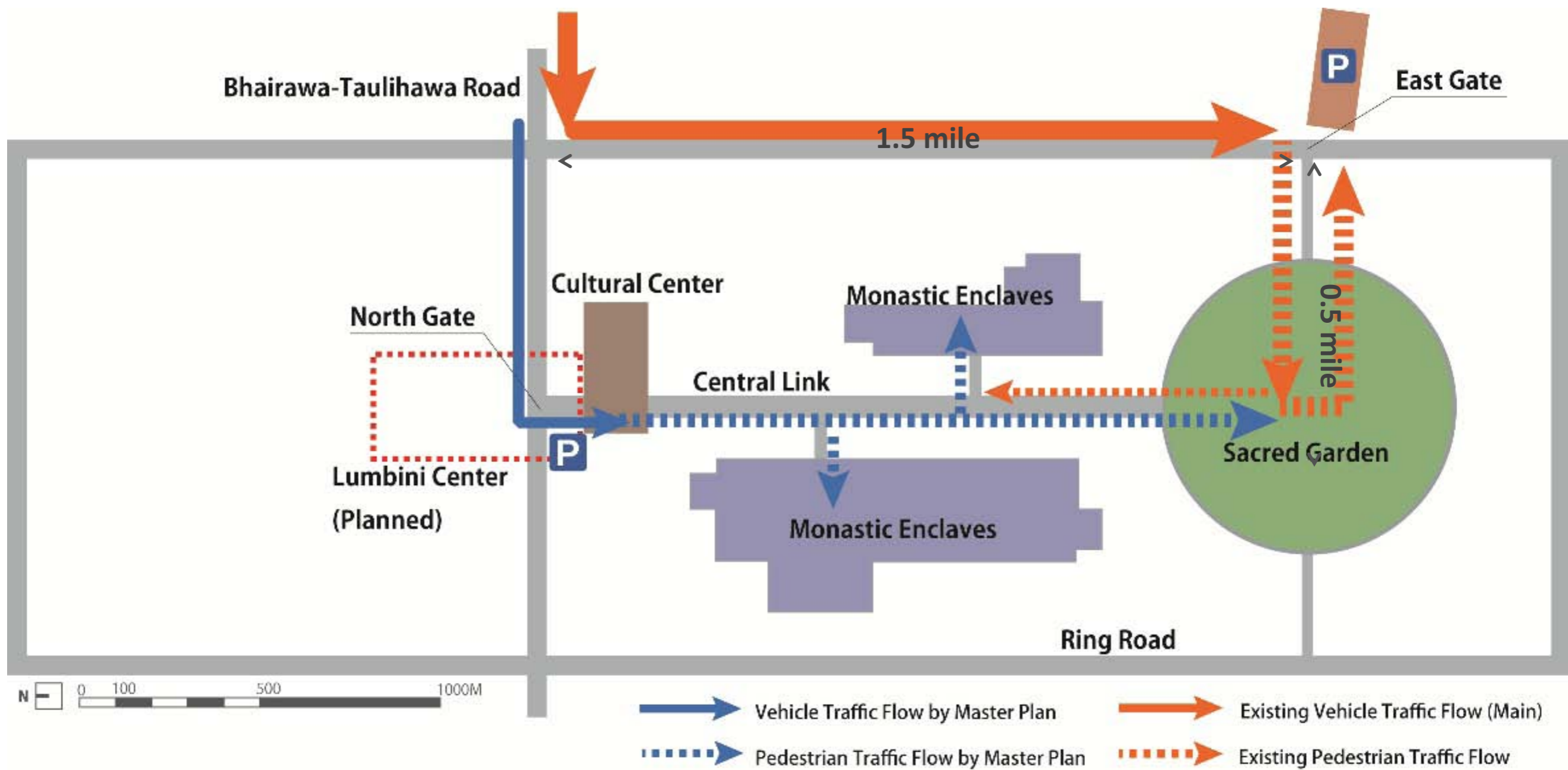

Integrated Management Plan for the Sacred Garden

End of Phase I (~2013)

Principle & Implementation

Access Management:

Transfer the Traffic Flow of Tourists/Pilgrims from East Garden Gate to North Garden Gate.

1. Set a New Ticket Booth/Information beside the North Garden Gate.
2. Set a New Temporary Ticket Booth beside the East Garden Gate.
3. Remove existing Ticket Booth and Information Center in the World Heritage Site.

* As a transitional period, Tourists and Pilgrims' Access from both North & East Garden Gate will be allowed during until Phase II.

Landscape Management:

Existing Structures & Facilities: Eliminate immediate threat to the site to preserve the visual and spiritual essence of the SG.





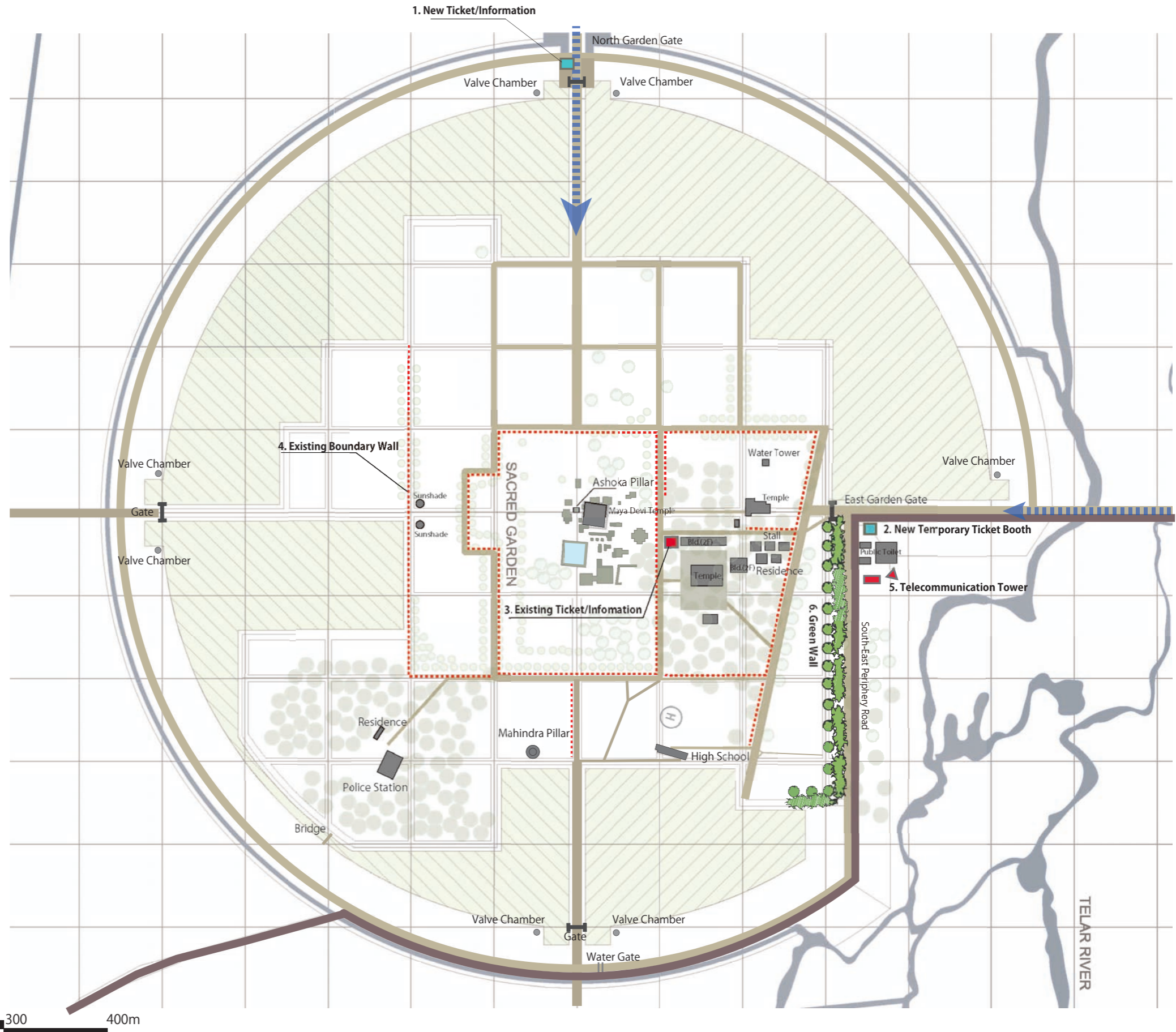

4. Remove all the existing boundary walls inside the SG.
5. Relocate existing Telecommunication Tower in the East Garden Gate.

Greening: Create sense of isolation from surrounding environment.

6. Plant new trees along the South-East Periphery Road of SG to form a Green Wall in order to separate the existing access road for the local residents from the SG.



Legend

-  Gate
-  Road
-  Access Road for Local Residents
-  Traffic Flow
-  Existing Building/Facility to be removed
-  Existing Boundary walls to be removed



0 100 300 400m

施設計画

FACILITY PLANNING

PLAN B

SCALE 1:20

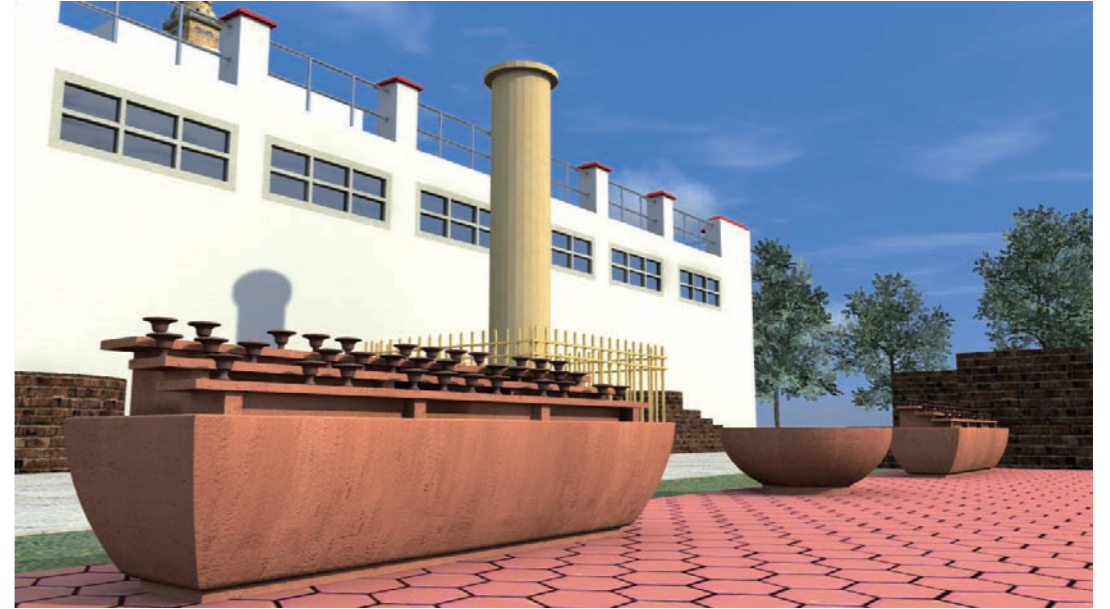

IMAGE

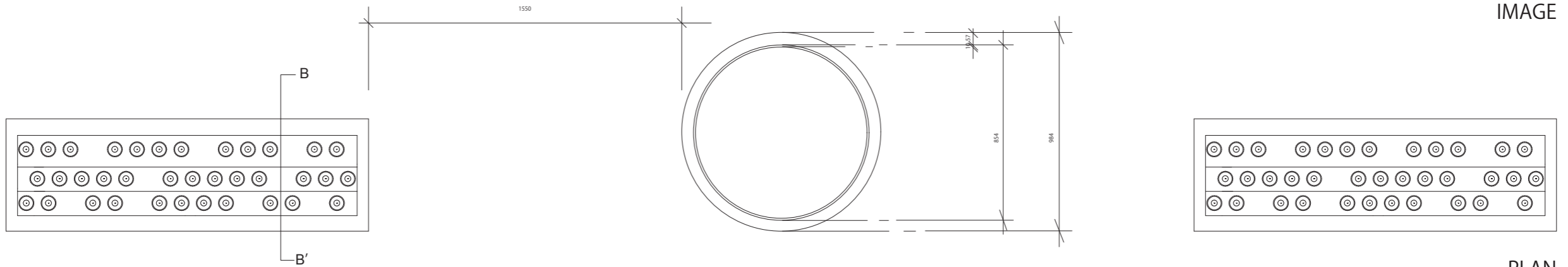

PLAN

Plan B

Pros: None transparent structure consistent with surrounding archaeological remains compared to Plan A, combined with relatively simple structure which is also easy for maintenance.

Cons: A few more complex parts than Plan A.

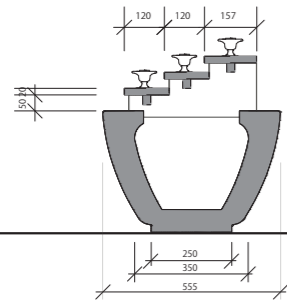
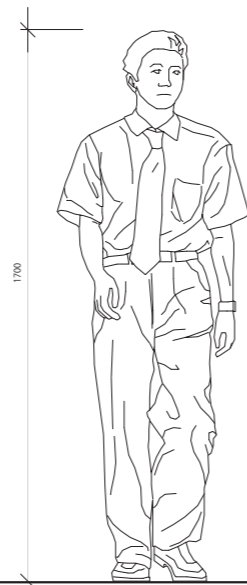

SECTION B-B'

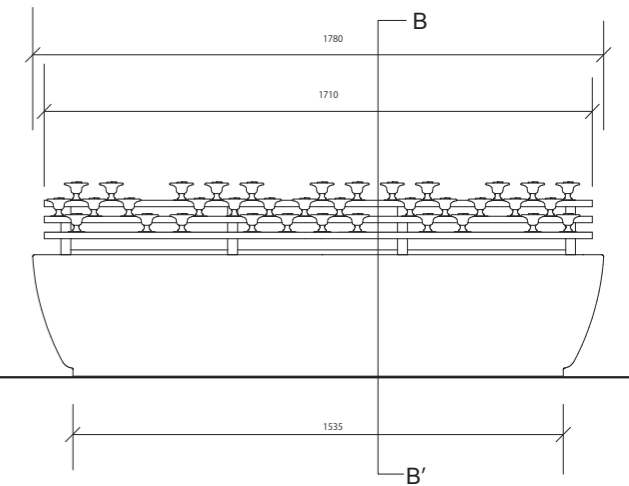
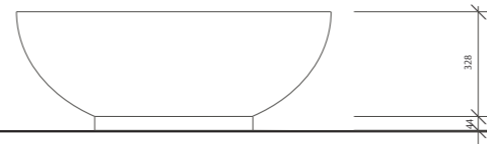

ELEVATION

Section (A-A')

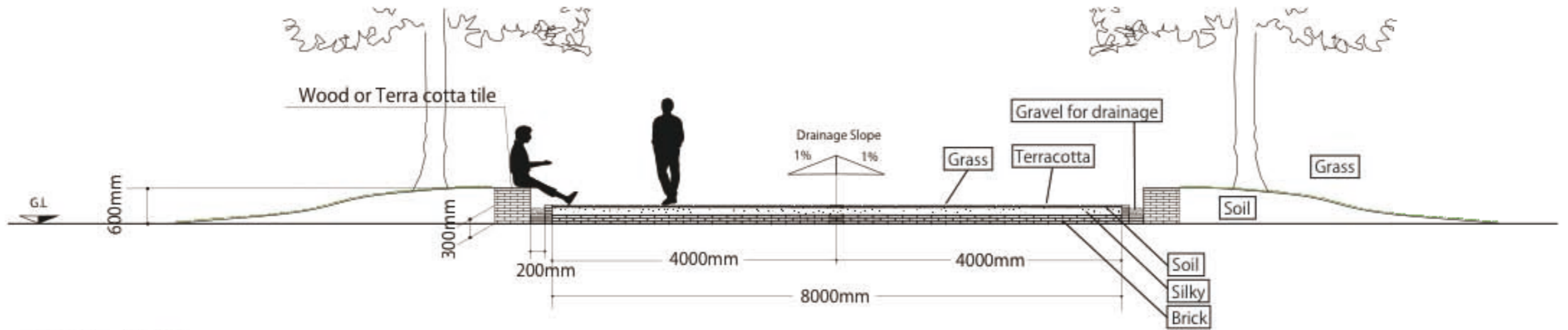

Section (B-B')

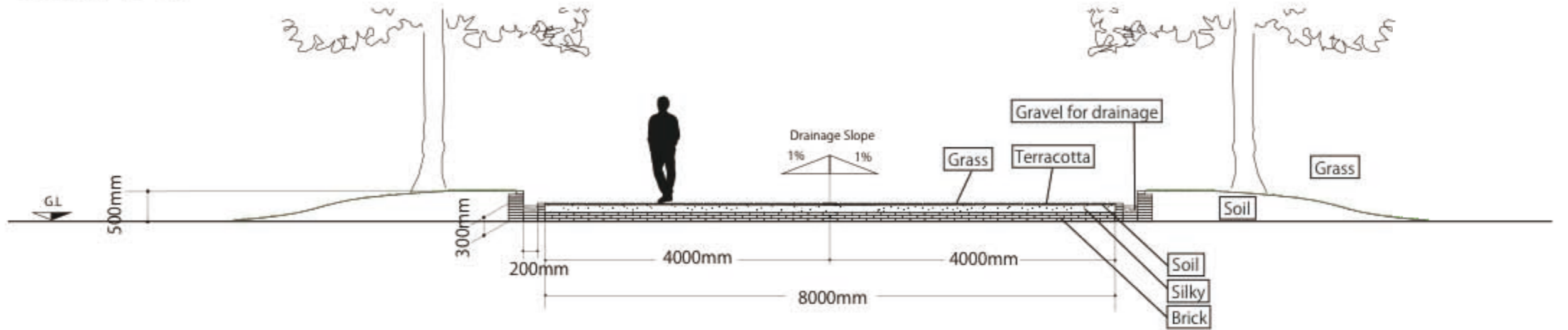

Section (C-C')

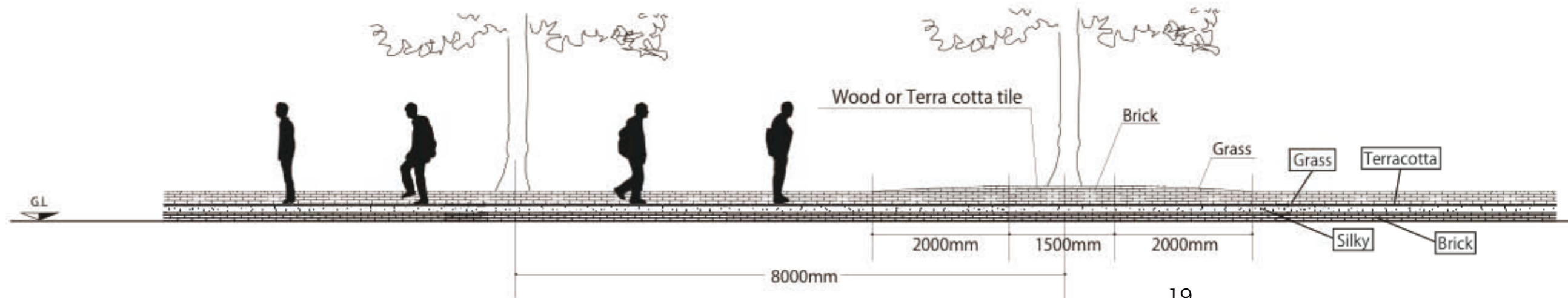

Details of Pavement
(Levee)



Brick

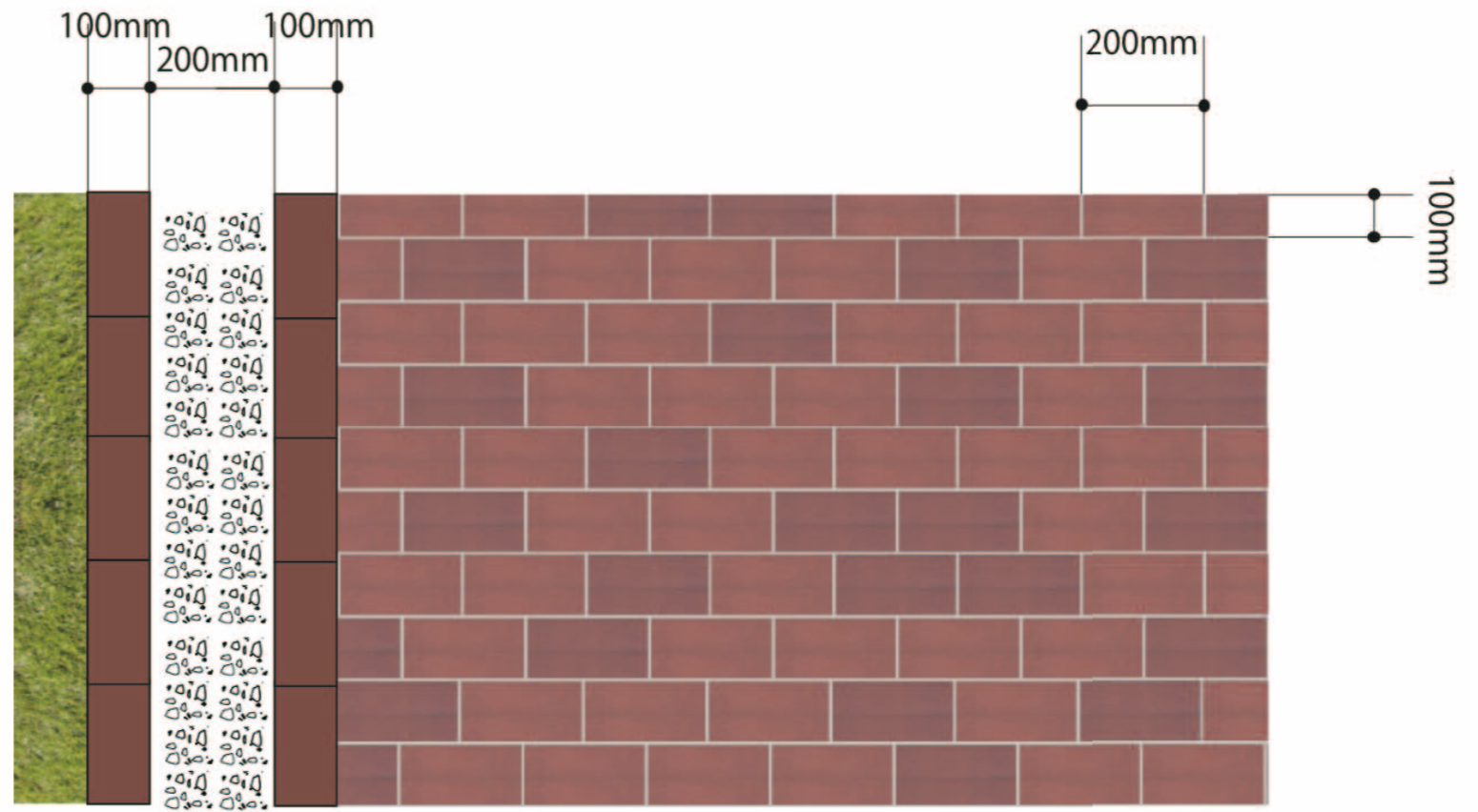

Pattern of Covering with Pavement Plan

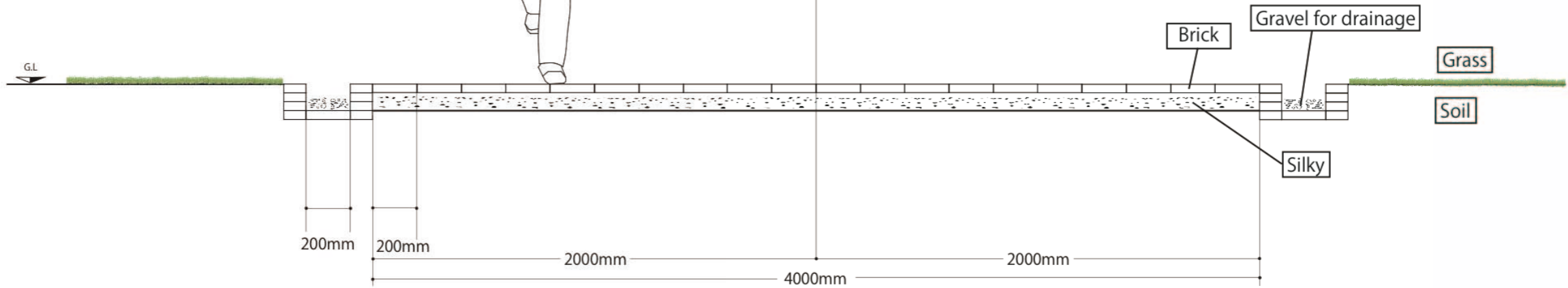
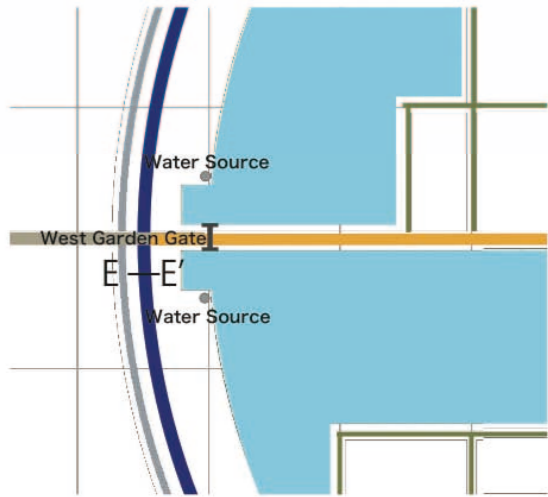

Section (E-E')

交通計画

TRANSPORT PLANNING



-Increasing Visitors in Lumbini (Foreign Visitors)



Tourists Arrival in Lumbini

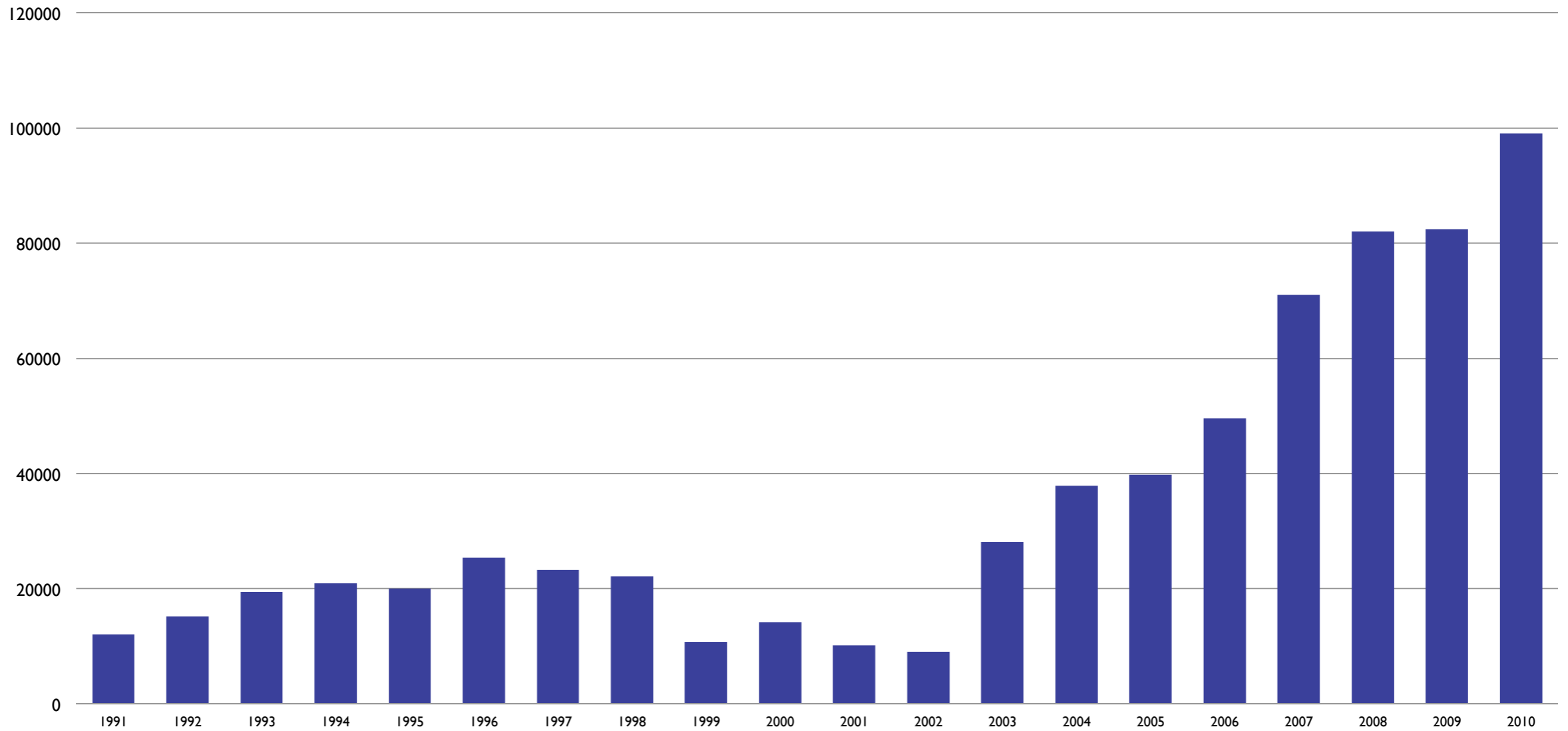

■ Tourist Arrival in Lumbini (Nepal & India not included)



-Expectation of the number of the future visitors 2008~2028.

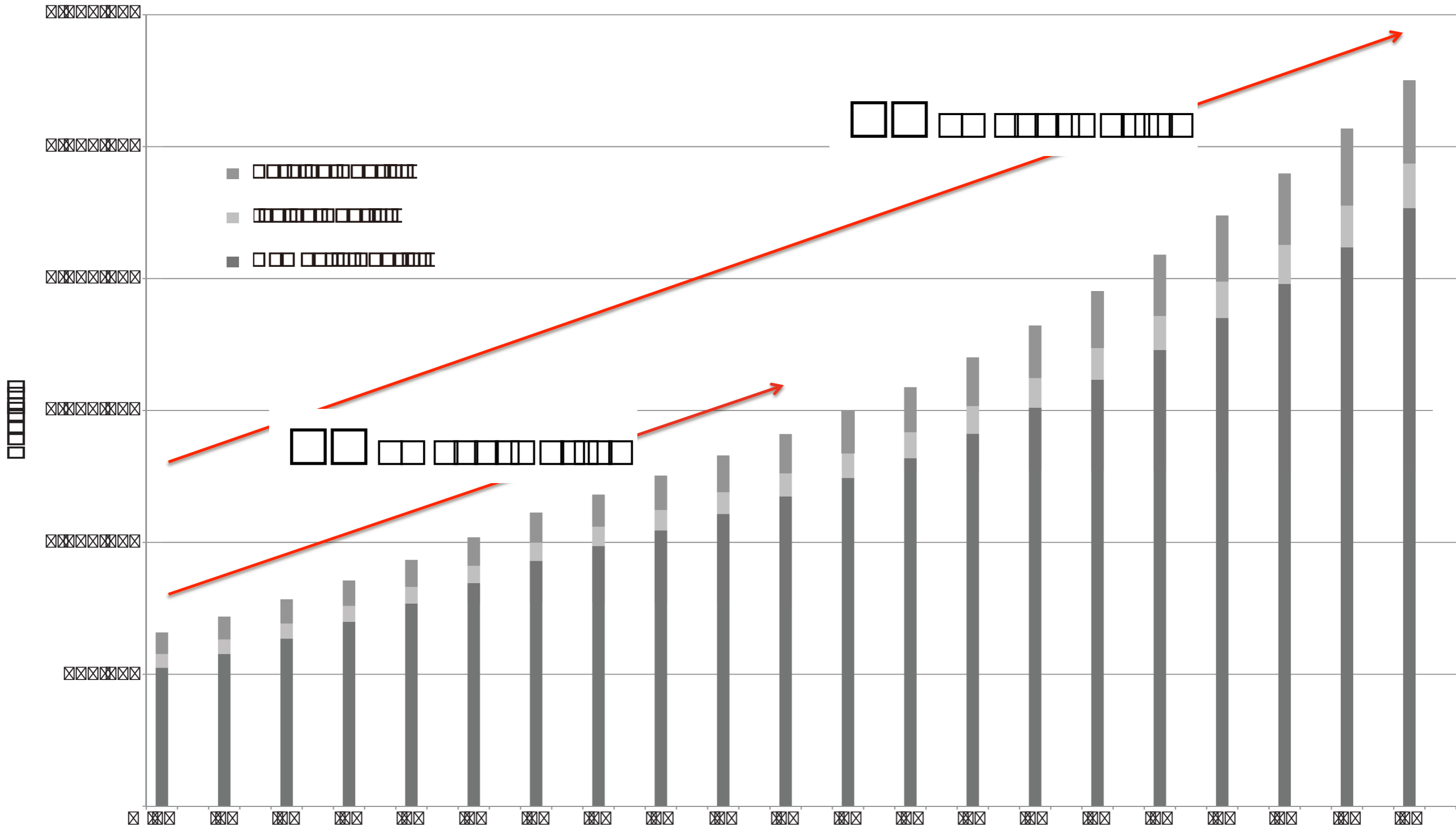

-Survey Overview-

Understanding the traffic flow to/from SG based on the number of people going in/out from East Gate and North Gate

Survey Condition

29/DEC/2011 8:00-17:00

Place: East Gate, North Gate(Bridge near the Lumbini Center)

Record the number of people going in/out to SG per a hour.



-The Result of Survey-

Compared to Walking Tourists Flow

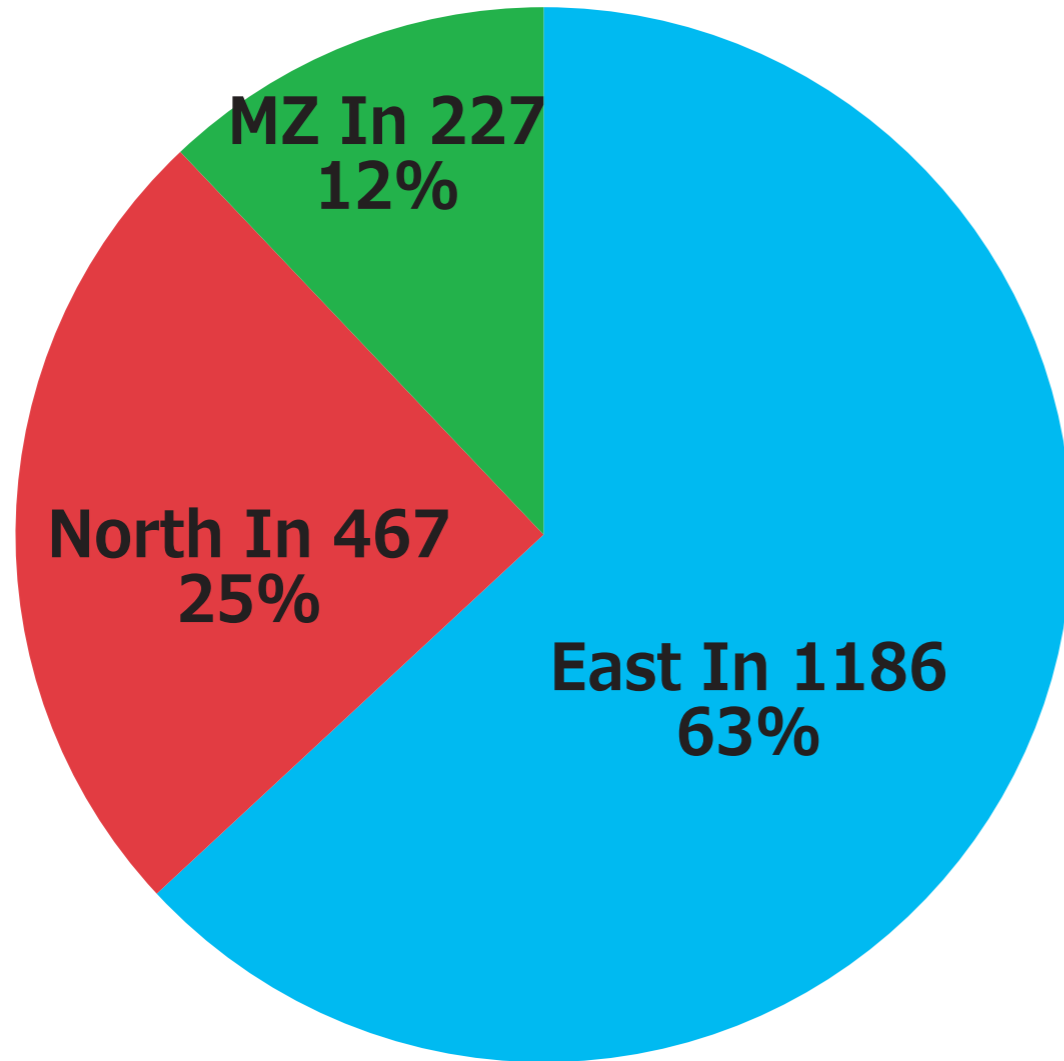

Go In (1880 persons)

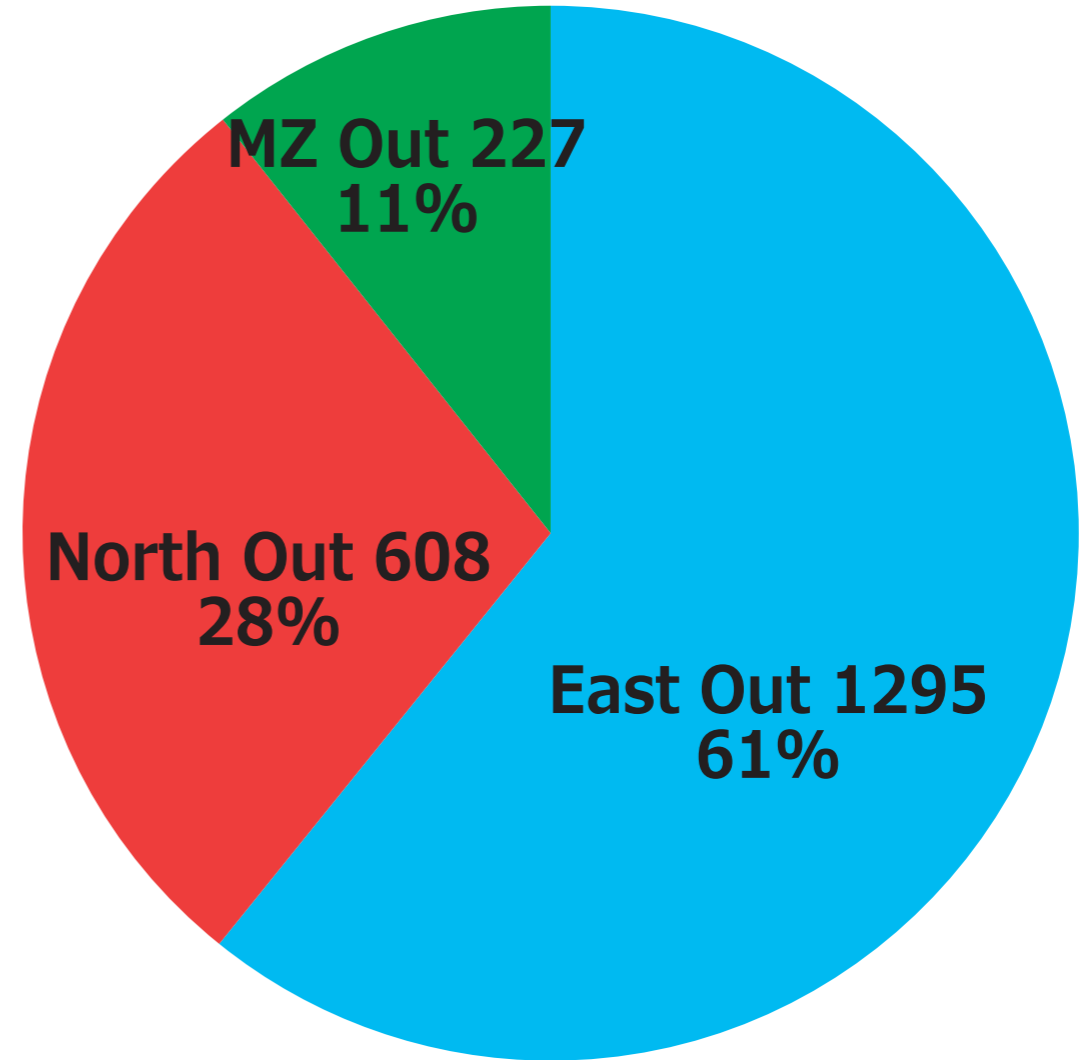

Go Out(2130 persons)

In the future, we expect that about 90% visitors come from North Gate.
 $1300 \times 90 (\%) = 1170 \approx 1200$ (persons/h)

29/DEC/2011 8:00-17:00

MZ In/Out: Numbers of pilgrims stayed in Temples(29th-30th)

Myanmar golden Temple:58 Korean Temple:69 Royal Thai Monastery:30 International Gantami Nuns' Temple:70

Important visual axis

重要な眺望





Route

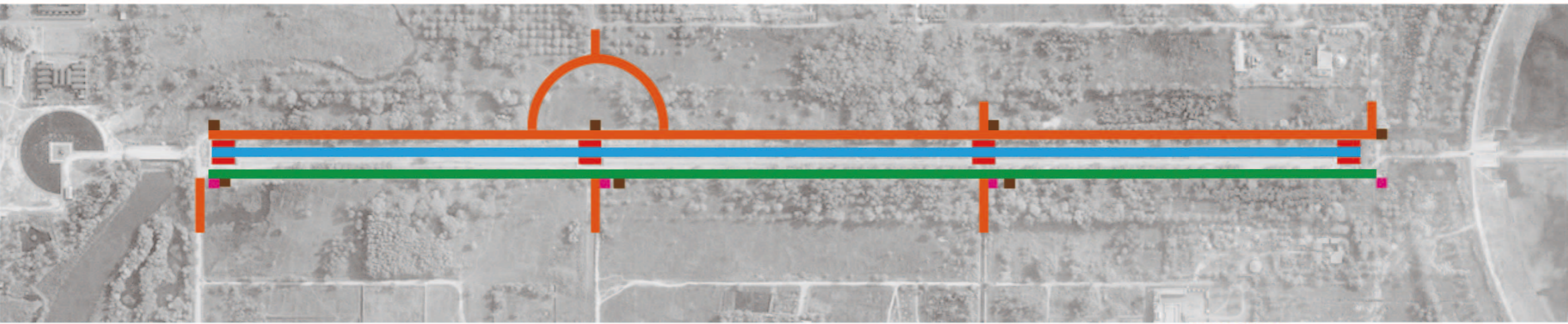

Rickshaw Bicycle
Boat
Electric Cart

Station Station Pier

Section

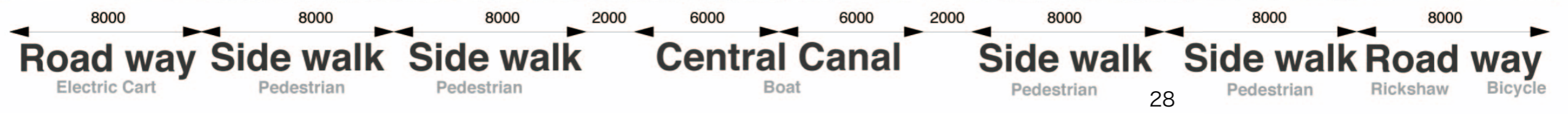

仏教遺跡群の調査

RESEARCH OF BUDDHIST SITES

The region of Lumbini and its Buddhist sites

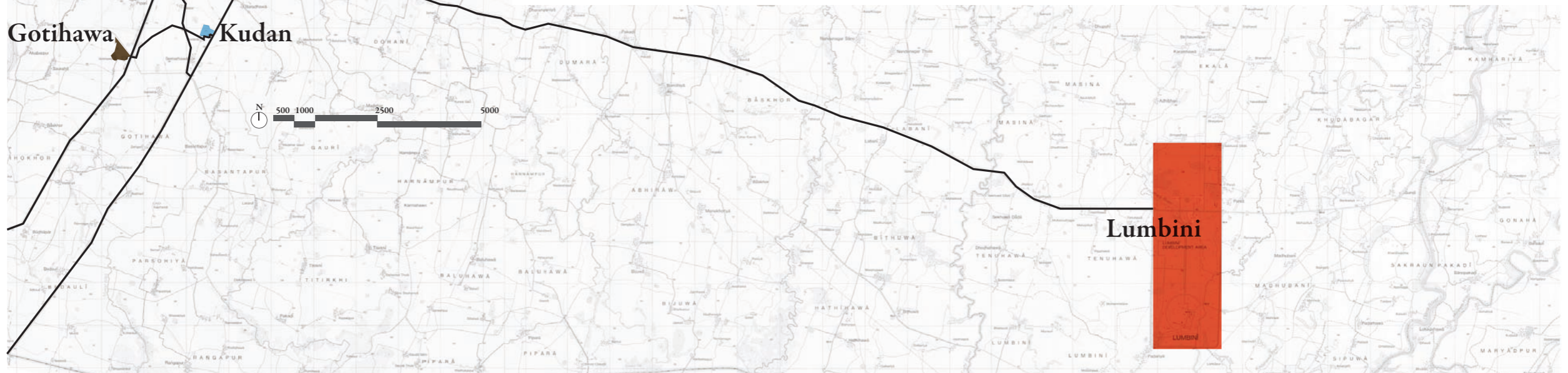
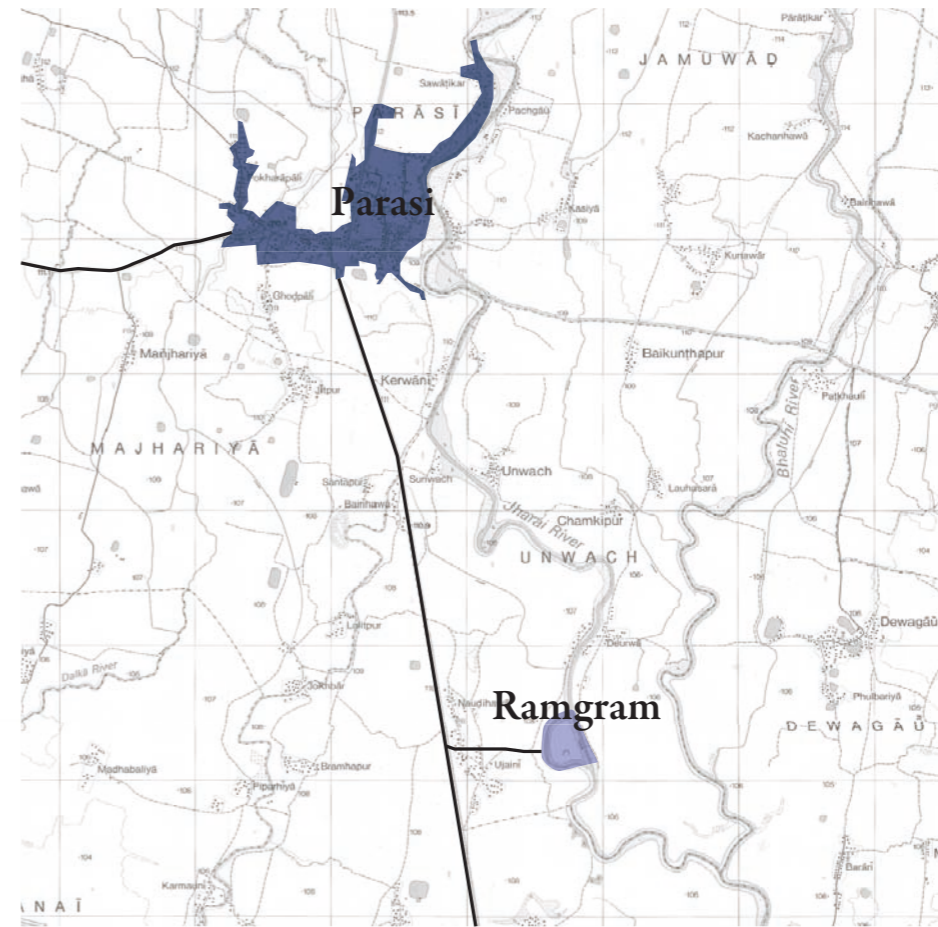
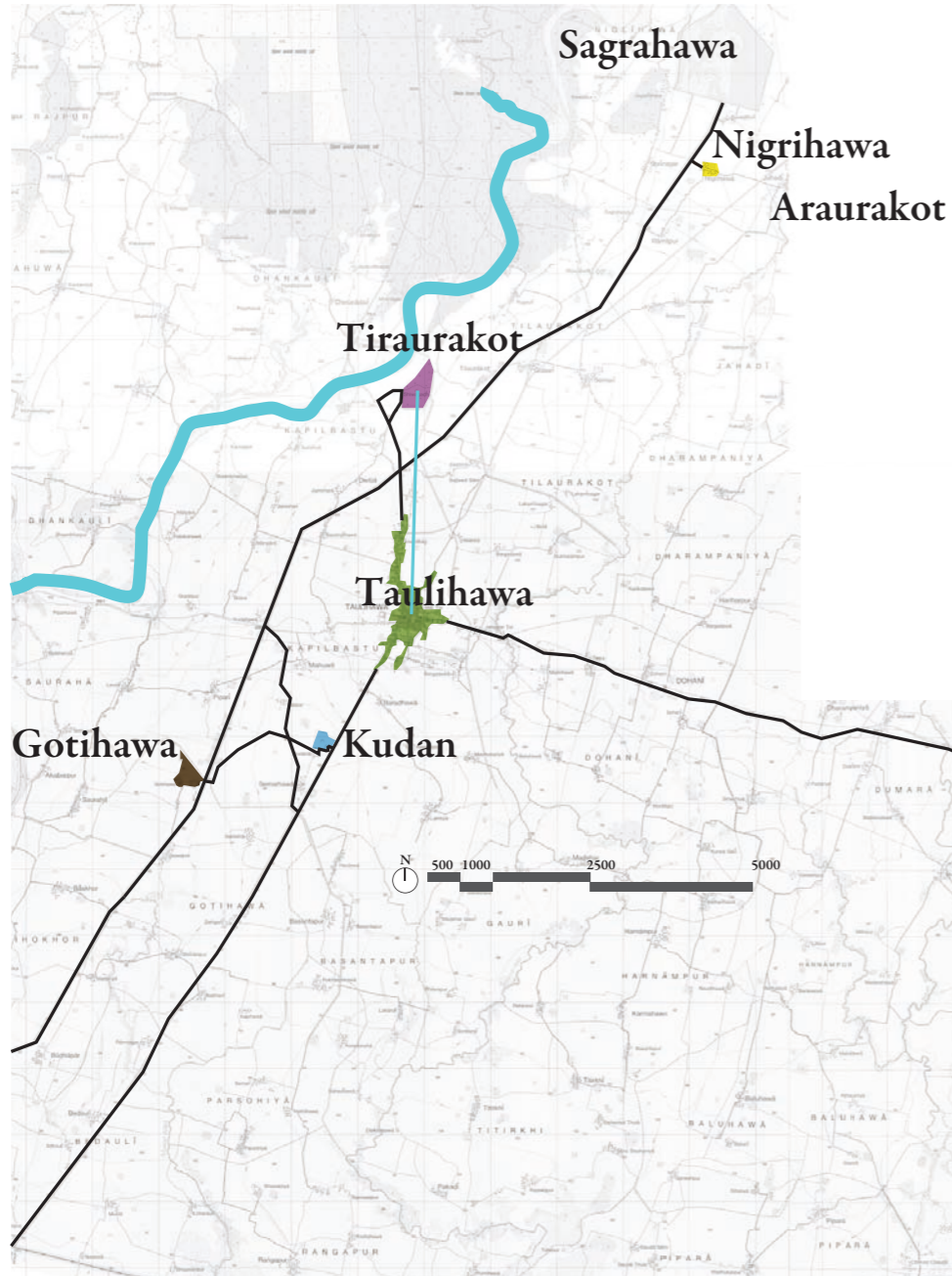

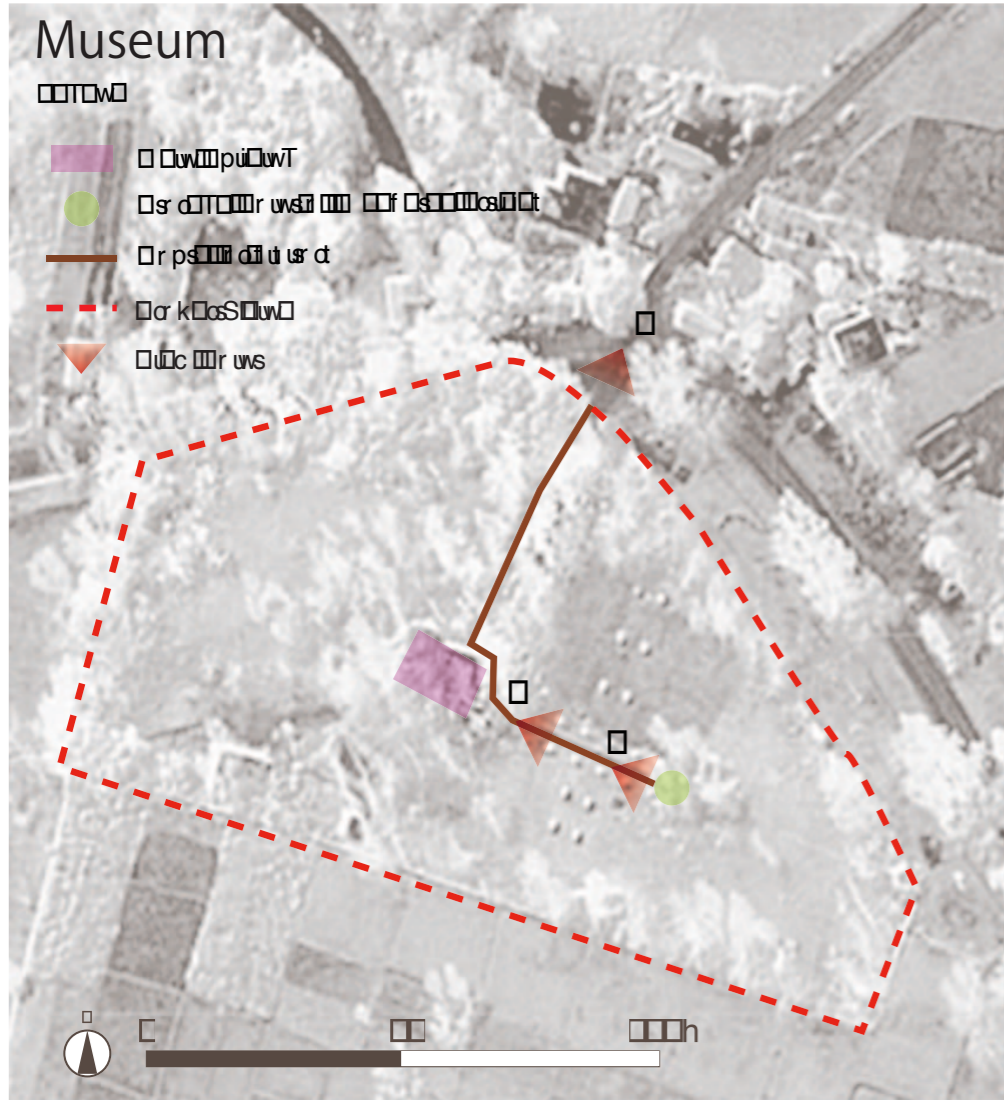

Or h h cōw
 Or ttu w tōw r w s tō s a h p tō ph tō cōw dō tō s a cōw sō wō r
 Cū pō r s tō r h tō s a dō k iō tō uō tō p i a cō
 Or p tō tō wō a r k tō cōw wō w sō w tō w s a i cō w t a r c a r r
 tō h tō s a uō cōw cōw tō u iō h tō wō h k r cō w s k iō tō c a pō r w s
 s tō u s tō pō r s tō w s a cō pō
 C a dō tō h tō i h p tō ph tō w sō w tō r h tō k r sō sō p wō w s a cō w
 C wō w tō r p wō wō wō kō wō u iō sō kō pō tō cō sō wō h tō
 k h tō a cō sō wō h tō r tō k h tō h tō u r wō tō
 Or cō r h tō fō sō wō cō tō cō w a u sō wō w tō cō s a dō cō wō
 □



1. 2. 3. 4. 5. 6. 7. 8. 9. 10. 11. 12. 13. 14. 15. 16. 17. 18. 19. 20. 21. 22. 23. 24. 25. 26. 27. 28. 29. 30. 31. 32. 33. 34. 35. 36. 37. 38. 39. 40. 41. 42. 43. 44. 45. 46. 47. 48. 49. 50. 51. 52. 53. 54. 55. 56. 57. 58. 59. 60. 61. 62. 63. 64. 65. 66. 67. 68. 69. 70. 71. 72. 73. 74. 75. 76. 77. 78. 79. 80. 81. 82. 83. 84. 85. 86. 87. 88. 89. 90. 91. 92. 93. 94. 95. 96. 97. 98. 99. 100.



Proposal of land use control

Core Zone

The area of Core Zone is 200m from the Monument Zone.

Since this area is also important in archaeologically and landscape, Construting and commercial activities is prohibited in this area.

Prohibited Developing Zone

To protect the surrounding environment and landscape, land use is regulated along roads, rivers and canals.

Inside this zone is essentially limited to agricultural use.

(Especially in the south and west)

Inside this zone, car traffic is prohibited.

Inside this zone, reconstruction of housing is only admitted. But the building is within second floor limit.

Buffer Zone

The area of Buffer Zone is 2000m from the Monument Zone.

This zone can cover major villages near Tilaurakot to control the land use.

Basically, the development is permitted.

But the height is limited to the second floor.

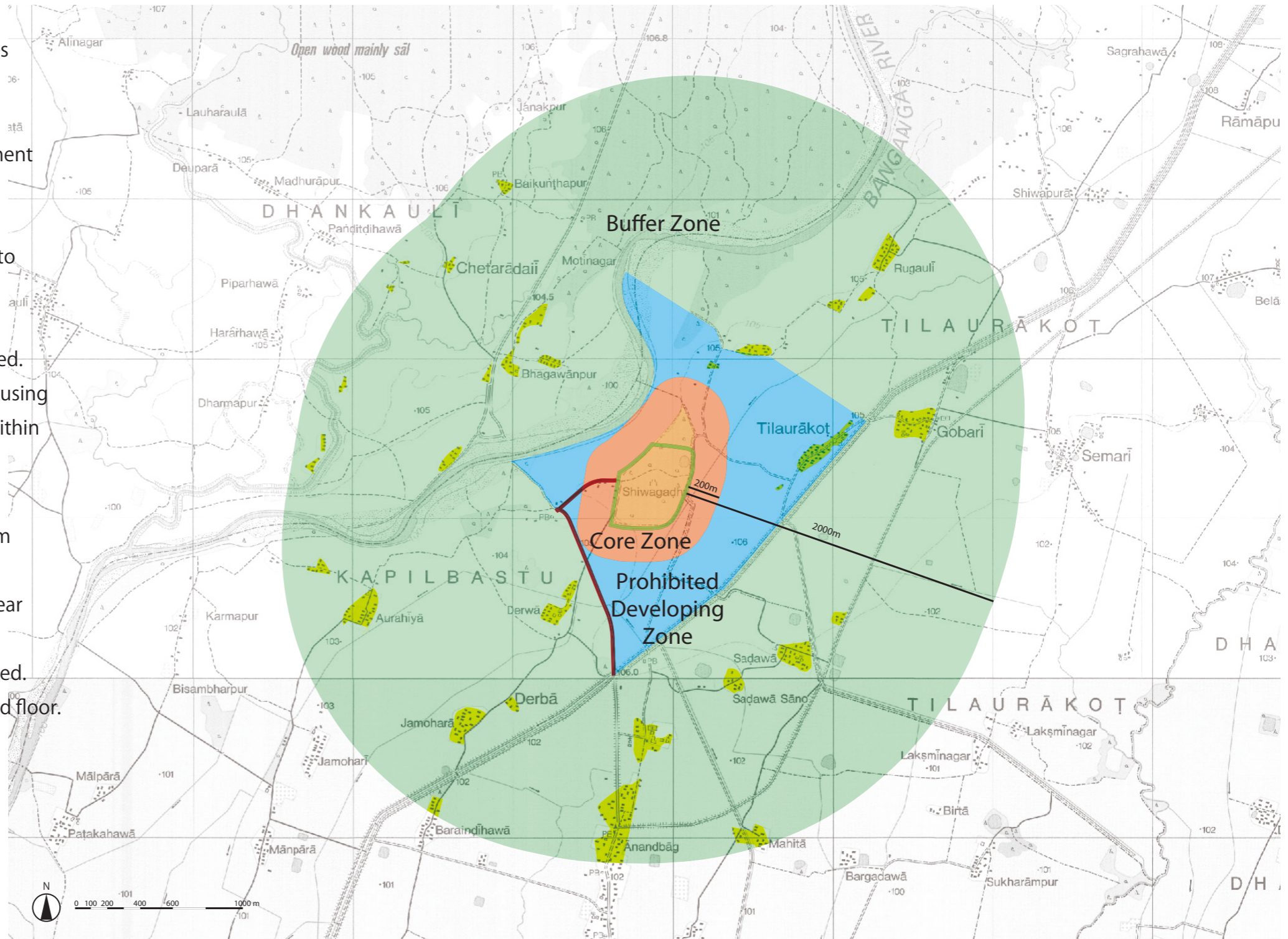

- Legend
- Fence
 - Monument Zone
 - Core Zone
 - Prohibited Developing Zone
 - Buffer Zone
 - Residential Area
 - Roadside Control Zone

丹下健三先生の意志を継いで

SUCCEEDING THE WILL OF KENZO TANGE

その国の在り方、世界遺産の在り方を考える

今年度は、1名募集。

Any question

M2仲村(don-nakamu@ud.t.u-tokyo.ac.jp)